

## Specifications

### Built-in flash memory

M2GD55: 2 GB\*1  
M1GD50: 1 GB\*1

### Headphone output

: 3.5 mm stereo mini jack  
: 5.0 + 5.0 mW/ 16 Ω

### USB jack

: USB 2.0 (Full Speed)/ USB 1.1

### Display

: 1 inch OLED

### Main unit dimensions (W × H × D)

M2GD55  
: 38.0 mm × 92.5 mm × 11.5 mm  
(1-1/2 × 3-5/8 × 7/16 inch)  
M1GD50  
: 38.0 mm × 92.5 mm × 12.5 mm  
(1-1/2 × 3-5/8 × 1/2 inch)

### Weight (Net)

: Approx. 38 g  
(Approx. 0.08 lbs)

### Operational Temperature Range

: 5 °C – +35 °C (without condensation)

### Battery type

: Built-in Li-ion rechargeable battery

### Battery operation time \*2

MP3 (128 kbps): Approx. 21 hours  
WMA (128 kbps): Approx. 16 hours

### Maximum number of files

: 1,000

### Max. recording time/ tracks \*3

M2GD55: Approx. 32 hours/  
Approx. 480 tracks  
M1GD50: Approx. 16 hours/  
Approx. 240 tracks

- Kenwood follows a policy of continuous advancements in development. For this reason specifications may be changed without notice.

### Playback format

#### MP3

Sampling rate: 32/ 44.1/ 48 kHz  
Bit rate: 16 - 320 kbps  
Variable bit rate: 16 - 320 kbps  
ID3 tag: ver. 2.2/ 2.3/ 2.4

#### WMA (DRM compatible)

Sampling rate: 32/ 44.1/ 48 kHz  
Bit rate: 32 - 320 kbps  
Variable bit rate: 32 - 355 kbps  
(Not supported by Professional, Lossless, or Voice.)

### PC system configuration requirements \*4

#### OS

: Microsoft® Windows® Vista/  
XP/2000 (Not supported by 64 bit version OS.)

#### USB connector

: Compliant to USB 1.1/2.0 standard

- \*1 The actual available space may be smaller than specified due to the presence of the system file area.
- \*2 Typical value when the provided headphones are used in the "Normal" sound mode. This value is not a guaranteed value. It may be shorter depending on the ambient temperatures and operating conditions.
- \*3 Assuming that each tracks is in the 128 kbps MP3/WMA format with playback time of about 4 min.
- \*4 All of the above specified PC environment does not guarantee full operation of the Player. Use a PC in which either OS mentioned above is preinstalled. Operation is not guaranteed on a PC running an upgraded OS or a PC assembled by yourself.

# KENWOOD

## DIGITAL AUDIO PLAYER

# M2GD55 M1GD50

## QUICK START MANUAL

Kenwood Corporation

### Reading the PDF Instruction Manual

The Instruction Manual is saved as a PDF file in the following folder of the Player. Copy this file into your PC before reading it.

MTP: [My Computer] – [Kenwood M\_D5\*] – [Internal Storage] – [Manual]

: [My Computer] – [M\_D5\*] – [Data] – [Manual]

MSC: [My Computer] – [KENWOOD\_DAP] – [Manual]

Refer to <Recharging Battery/ Connecting a PC> for details.



© B60-5705-08/00 (E)

## Safety precautions

### IMPORTANT SAFETY INSTRUCTIONS

#### ⚠ Caution:

Read this page carefully to ensure safe operation.

**Read Instructions** – All the safety and operating instructions should be read before the product is operated.

**Retain Instructions** – The safety and operating instructions should be retained for future reference.

**Heed Warnings** – All warnings on the product and in the operating instructions should be adhered to.

**Follow Instructions** – All operating and use instructions should be followed.

#### WARNING :

- **Do not use headphones during riding/ driving a vehicle or walking.** Otherwise, a traffic accident may result. Never use headphones when you ride a bicycle or driving an automobile or motorbike. If the Player is used during walking, the ambient sounds will be cut and you may have difficulties in hearing various warning sounds.
- **Do not operate the Player during riding or driving a vehicle.** Do not operate the Player when you drive or ride an automobile, motorbike or bicycle. Otherwise, a traffic accident may result. Be sure to stop the vehicle in a safe place before operating the Player.
- **Do not stare at the display screen during riding or driving a vehicle.** Otherwise, a traffic accident may result.
- **Do not leave the ear tips provided with the Player in the reach of children.** There has been a case in which a child swallowing a small item was suffocated to death. If a child swallows an ear tip by accident, immediately take the emergency measure to let the child vomit it out and see a doctor.

- hearing ability may be damaged.
- Do not use headphones if an abnormality is felt on the skin. Otherwise, skin inflammations may result. Should any abnormality be felt on the skin or ears during use of headphones, immediately stop using them and see a doctor.
- A person with an ear disease is discommended to use headphones. Otherwise, the disease may worsen. Should any abnormality be felt on the skin or ears during use of headphones, immediately stop using them and see a doctor.
- Be sure to attach the ear tips firmly. If the ear tips are attached insufficiently to the headphones, an ear tip may drop out, enter the deep of the ear and injure it. Should an ear tip drop out inside an ear, see a doctor.
- Attach and detach headphones around the ears gently and slowly. Violent attaching or detaching may injure the ear.

#### Handling

- Do not apply an excessive force to the display part. Otherwise, it may be damaged.
- Avoid storing the player in a bag together with a hard object. Otherwise, the player may be damaged when the bag is pushed.
- Do not expose the player to an insecticide or other volatile substance or bring the player in extended contact with a rubber or vinyl material. Otherwise, discoloration or peeling of the surface finish may result.
- Do not put the player in a pocket of trousers. Otherwise, it may be damaged due to a strong impact when you sit down, etc.
- **Protect the player against sweat and moisture.** Do not use the player by putting it in a breast pocket for long hours in the summer or during exercise. Otherwise, penetration of moisture or sweat may cause malfunction or failure.

#### Operating conditions

Temperature: 5 to 35°C. (without condensation)

#### Maintenance of the unit

When the front panel or case becomes dirty, wipe with a soft, dry cloth. Do not use thinner, benzine, alcohol, etc. for these agents may cause discoloration.

#### Note on the built-in battery

- For the replacement of the built-in battery, contact your dealer.
- The battery built into the player discharges spontaneously even when the player is not used. This means that the built-in battery may be exhausted completely when the player is left unused for a long period. If this happens, recharge the battery before using the player.
- The battery recharging time is variable depending on the condition of the battery and ambient temperature.
- The available playback time reduces when the player is used under low temperatures.
- The built-in battery can be recharged for about 500 times. (This is a reference value and is not guaranteed.)
- The built-in battery is a consumable part, and the available playback time reduces gradually after repeated use. If the available playback time becomes very short even after the battery has been recharged fully, the battery may be degraded; replace it with new one.
- Kenwood will not assume any liabilities for the alteration or loss of data caused due to complete discharging of the built-in battery.
- The built-in battery is a lithium ion battery. It is free from the memory effect of Ni-Cad and nickel-hydrogen batteries, with which the capacity decreases if the battery is charged or discharged incompletely for several times. The built-in battery therefore accepts additional charging before it has exhausted completely.

#### Notes on using through

##### headphones:

- Do not start listening with too high a volume. Otherwise, sudden output of a high-volume sound may cause hearing failure, etc.
- Do not listen to the audio with an extremely high volume for long hours. Otherwise, your

## Recharging Battery/ Connecting a PC

Using the provided USB cable, connect the Player to a PC. This makes it possible to transfer music from the PC to the Player and to recharge its battery.

### Recharging Battery

Open the USB cover.

Using the provided USB cable, connect the Player to a PC.

Recharging is complete when the indicator of the Power/Menu button turns off. Recharging completes in about 3.5 hours.

The method for disconnection from the PC after recharging is variable depending on the connection mode. For details, see <Disconnecting the Player from the PC>.

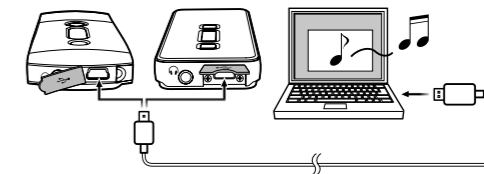

- Start up the PC before connecting the Player.
- The Player is switched ON automatically at the moment it is connected to the PC.
- When the USB connection, always use a supplied USB cable.
- The Player should be connected directly to the USB port of the PC. We cannot guarantee the operation if the player is connected via a USB hub.

### Recharging and battery indication

#### On-screen icons

	Shows the remaining power of the battery.
	Indications during recharging.
	The battery is nearly exhausted. Recharge it if it is rechargeable.
	The battery is not inserted or not rechargeable.

#### Power/Menu button's indicator (during USB connection)

ON	The indicator lights during recharging.
OFF	The indicator is extinguished when recharging completes.
Blink	Data is being transferred between the player and the PC.

### Connecting a PC

Connect the Player to a PC to transfer music from the PC to the Player and to recharge its battery.

The connection mode varies according to the OS running on the PC and the version of Windows Media Player.

OS	Windows Media Player			Windows Media Player not installed
	11	10	9	
Windows Vista	MTP	—	—	MSC
Windows XP (SP1/SP2)	MTP	MTP	MSC	MSC
Windows 2000	—	—	MSC	MSC

### Reading the PDF Instruction Manual

The Instruction Manual is saved as a PDF file in the following folder of the Player. Copy this file into your PC before reading it.

MTP: [My Computer] – [Kenwood M\_D5\*] – [Internal Storage] – [Manual]

: [My Computer] – [M\_D5\*] – [Data] – [Manual]

MSC: [My Computer] – [KENWOOD\_DAP] – [Manual]

After copying, you may delete the PDF file to increase the space for transferring more files. If you delete the PDF file by mistake, you can transfer it from the Kenwood website.

### Disconnecting the Player from the PC

When the connection mode is MTP mode

(When "Kenwood M\_D5\*" or "M\_D5\*" is displayed on Windows)

#### 1

##### Unplug the USB cable from the Player.

Ensure that the indicator of the Power/Menu button is not blinking before unplugging the USB cable.

When the connection mode is MSC mode

(When "KENWOOD\_DAP" is displayed on Windows)

#### 1

##### Click the [Safe To Remove Hardware] icon.

Display the indicator on the task tray if it is not displayed.

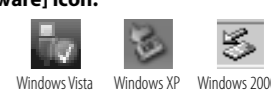

#### 2

##### Click [Safely remove USB Mass Storage Device].

When the message showing that the Player can be disconnected safely, disconnect it from the PC.

## KENWOOD

### For your records

Record the serial number, found on the back of the unit, in the spaces designated on the warranty card, and in the space provided below. Refer to the model and serial numbers whenever you call upon your dealer for information or service on this product.

Model \_\_\_\_\_ Serial Number \_\_\_\_\_

## Unpacking

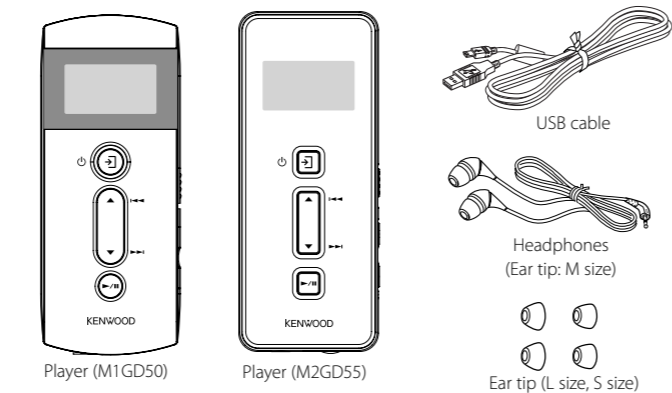

## CE Declaration of Conformity with regard to the EMC Directive 2004/108/EC

### Manufacturer:

Kenwood Corporation  
2967-3 Ishikawa-machi, Hachioji-shi, Tokyo, 192-8525 Japan

### EU Representative's:

Kenwood Electronics Europe BV  
Amsterdamseweg 37, 1422 AC UITHOORN, The Netherlands

## Information on Disposal of Old Electrical and Electronic Equipment (applicable for EU countries that have adopted separate waste collection systems)

Products with the symbol (crossed-out wheeled bin) cannot be disposed as household waste. Old electrical and electronic equipment should be recycled at a facility capable of handling these items and their waste byproducts. Contact your local authority for details in locating a recycle facility nearest to you. Proper recycling and waste disposal will help conserve resources whilst preventing detrimental effects on our health and the environment.

### Trademark Information

- "Microsoft" and "Windows Media" are trademarks or registered trademarks of Microsoft Corporation in the USA and other countries.
- "Adobe Reader" is a trademark of Adobe Systems Incorporated.

Other system names and product names are also trademarks or registered trademarks of their respective developers. Note that the "™" and "®" markings are omitted in the text of this manual.

English

English

## Capturing Music in PC/Transferring Music from PC

To play music files as tracks of this Player, first rip music files in the PC and then transfer them from the PC to this Player.

The Player can play the following 3 types of music files.

- MP3 (\*.mp3) : MPEG-1 Audio Layer-3
- WMA (\*.wma) : Windows Media Audio

For detailed specifications, see <Specifications>.

### Using Windows Media Player 11/10/9

A music CD can be ripped into the PC using the Windows Media Player 11/10/9.

(The following steps describes the operation with the Windows Media Player 10.)

- 1 Launch the Windows Media Player.
- 2 Click the [Rip] button on the top.
- 3 Place a music CD in the CD-ROM drive of the PC.
- 4 Check the checkboxes of the CD tracks to be ripped.
- 5 Click the [Rip Music] button.



For details, refer to the Instruction Manual in the PDF file. (page 11)

- 6 Click the [Sync] button on the top.
- 7 Select the MTP player (Kenwood M\_D5\* or M\_D5\*) or the removable disk (KENWOOD\_DAP) corresponding to this Player.
- 8 Add the music files to be transferred in the Sync List.
- 9 Click the [Start Sync] button.



For details, refer to the Instruction Manual in the PDF file. (page 13)

### Data transfer by drag & drop

Open the Windows Explorer and drag & drop the desired file from the PC's hard disk drive to this Player (expressed as MTP: [Kenwood M\_D5\*], [M\_D5\*] or MSC: [KENWOOD\_DAP] on Windows). Copy & paste can also be used for data transfer.

- 1 Open the MTP player or the removable disk corresponding to this Player.
- 2 Open the folder storing the desired music file.
- 3 Drag & drop the music file into the MTP player or the removable disk.

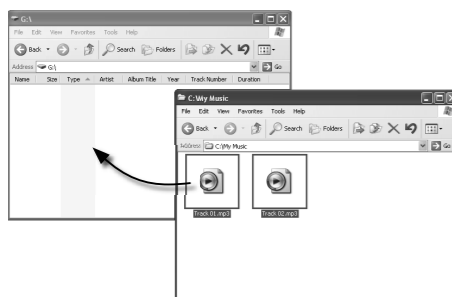

- MEMO**
- If copy protection is set, when capturing tracks of a music CD into the PC using the Windows Media Player, transferring the music file to the Player is limited only to the Windows Media Player. The music files which are transferred using drag & drop or copy & paste cannot be played.
  - Before transferring a music file, view it with the Windows Media Player to confirm that the genre, artist name, album title and track title are set correctly.

## Names and functions of parts

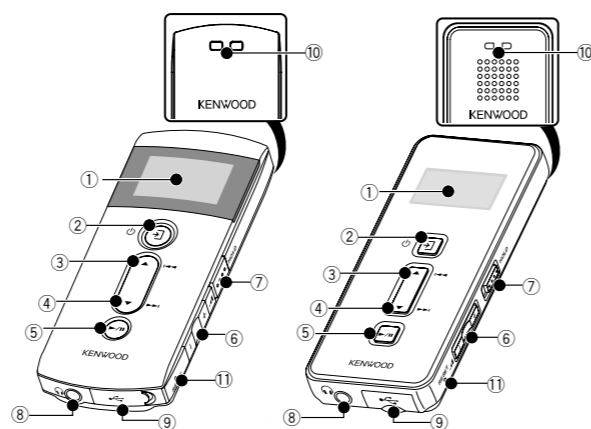

- 1 **Display**
- 2 **Power/Menu button**
  - Press and hold to switch the power ON/OFF.
  - Press shortly to open the menu.
  - Press shortly while the menu is open to return to the previous display page.
  - Press when the display is turned off (screen saver mode) to turn on the display.
  - Status indicated by the indicator

	During play	During USB connection
Steady lighting	Power is ON.	Recharging...
One blink per 3 sec.	Screen saver mode.	-
Two blinks per 3 sec.	Screen saver mode under Hold function activated.	-
Blink	-	Transferring data...
Extinguished	Power is OFF.	Recharging completed.
- 3 **▲ Up button**
  - Press to move the cursor upward.
  - Press during playback to skip to the beginning of the current track. Pressing the button at the beginning of a track skips to the beginning of the previous track.
  - Press and hold to fast reverse the music.
- 4 **▼ Down button**
  - Press to move the cursor downward.
  - Press during playback to skip to the beginning of the next track.
  - Press and hold to fast forward the music.
- 5 **▶/⏸ Play/Pause button**
  - Press to play a track or let it pause.
  - During playback, press and hold for more than 1 second to set the A-B Repeat points.
  - Press while the menu is displayed to enter a selected item.
- 6 **⏪ VOLUME button**
  - Press to increase (+) or decrease (-) the volume. Pressing and holding a button segment varies the volume gradually.
- 7 **HOLD switch**
  - Press to defeat all other buttons. This helps prevent erroneous operation of the Player when it is carried in a bag, etc.
- 8 **🎧 Phones jack**
  - Connect the provided stereo headphones.
- 9 **🔌 USB jack**
  - Connect to a PC using the provided USB cable to transfer music files or recharge the battery.
- 10 **Strap eyelet**
  - Pass the strap through this hole.
- 11 **Reset button**
  - In case of irregularity, first consult <Troubleshooting> (page 29 of the PDF manual). If an optimum remedy is not found, try pressing the reset button with the tip of a clip or ballpoint pen.

- MEMO**
- Do not pass a metallic hook or like (a key holder, etc.) through the strap eyelet. Otherwise, the player may be damaged.

## Cancelling the HOLD function

The HOLD function defeats all of the Player's buttons and helps prevent erroneous operation when the Player is carried in a bag, etc. The HOLD function should be canceled before using the Player.

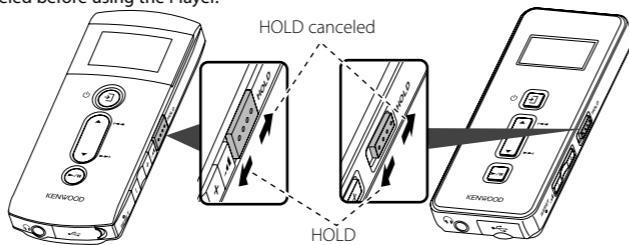

## Connecting stereo headphones

Connect the provided stereo headphones to the Player.

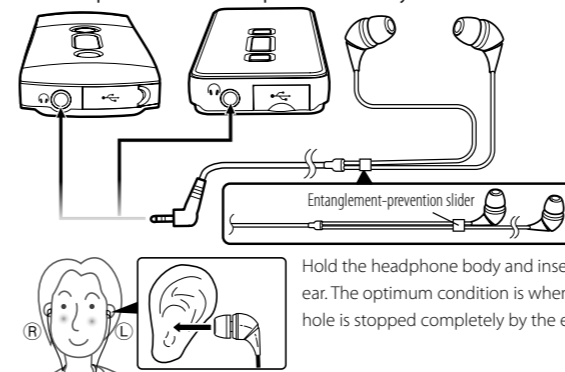

### Selecting the ear tips

The headphones are shipped from the factory with the M-size ear tips attached. If the M-size ear tips do not match your ears, replace them with the provided S-size or L-size ear tips.

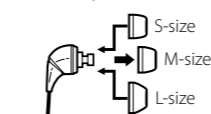

- MEMO**
- Always hold the headphone bodies when attaching or detaching headphones. Pulling a cord may result in malfunction.
  - To clean the ear tips, remove them from the headphone bodies and wash with a neutral detergent solution. After washing, wipe them dry before use.
  - The ear tips may deteriorate after a long period of use or storage.
  - To prevent the headphone cord from being entangled, slide the entanglement-prevention slider to fix the headphone bodies in position.

## Switching Power ON/OFF

- 1 **Switch the Player ON.**

Press and hold the Power/Menu button until the KENWOOD logo is displayed. The Player enters the mode before the last time it was switched OFF.
- 2 **Switch the Player OFF.**

Press and hold the Power/Menu button until the pattern shown on the left is displayed.

## Setting the display language

- 1 **Open the home screen.**

The home screen opens.
- 2 **Select "Settings".**
- 3 **Select "Language".**
- 4 **Select the language.**

Select the desired language.

## Selecting music for playback

Select and play the desired track.

Artist	Select Artist name → Album title → Track title.
Album	Select Album title → Track title.
Genre	Select Genre name → Track title.
Track	Select Track title directly.

When a major item is selected, the list of intermediate items located below it is displayed. Selecting "Play all" plays all of the currently selected music tracks.

- 1 **Connect headphones and switch the Player ON.**
- 2 **Open the home screen.**

The home screen opens.
- 3 **Select a major item ("Artist", for example).**

The list for the major item (intermediate items) is displayed.
- 4 **Select an intermediate item ("Artist name", for example).**

The list for the intermediate item is displayed.
- 5 **Select an intermediate item ("Album title", for example).**

The list for the intermediate item is displayed.
- 6 **Select a track ("Track title", for example).**

- MEMO**
- A track that does not contain tag information is classified as "Unknown".
  - Press the Menu button to return to the previous display page.

## Display during playback

The display shows various information during playback.

- 
- 1 Mode
  - 2 Artist name
  - 3 Track title
  - 4 Elapsed play time/Play time
  - 5 Track No./Number of selected tracks
  - 6 A-B Repeat (page 19 of the PDF manual)
  - 7 File format  
MP3: Playback of MP3 files.  
WMA: Playback of WMA files.
  - 8 Sound mode (page 21 of the PDF manual)
  - 9 Play mode (page 19 of the PDF manual)
  - 10 Sleep timer (page 22 of the PDF manual)  
⏰: Sleep timer on  
None: Timer off
  - 11 HOLD switch  
🔒: HOLD  
None: HOLD canceled
  - 12 Remaining battery power

- MEMO**
- The display is turned off automatically when the Player has not been operated for a certain period of time (screen saver mode). The Power/Menu button blinks every 3 seconds in the screen saver mode. The time until the screen saver mode is activated can be changed (page 23 of the PDF manual).
  - The Player switches OFF automatically after it has been left in pause mode for a certain period of time (Auto Power-OFF). The time until Auto Power-OFF occurs can be changed (page 23 of the PDF manual).