

KENWOOD

Steering Wheel Remote Control Adaptor

CAW-CCANPE1 & CAW-CANUN1

How to operate the original display of Citroen or Peugeot

Check for latest updates on:
www.kenwood.eu

PSA MENU SETTING

CAW-CCANPE1 & CAW-CANUN1 allows you to set some functions that usually are managed with the OEM head unit .

By making a simple and intuitive procedure it's possible to set functions such as:

- Hour
- Date
- Language
- General Setting

ATTENTION



THE MENU' AVAILABILITY IT'S UNDER TIME, IF ANY BUTTONS IS PRESSED WITHIN 30 SECONDS, THE SYSTEM EXIT AUTOMATICALLY. TO RESET THE SETTING FUNCTION ONCE ENDED THE MODIFICATIONS, DISCONNECT THE IGNITION KEY.

How to enter the menu setting

To enter the menu setting just turn on the ignition, switch OFF the radio, then press the sequence of buttons MODE and SEEK >> twice. Once done this operation the car display will visualize the voice MENU.



Each time we will press SEEK >> button, we will navigate the Main Menu.



To select one of the Sub Menu press SRC button.

In the example below we visualize DISPLAY ADJUST in which we can modify hours and date.



Each time we will press MEMO V button, we will navigate the DIPLAY ADJUST sub menu.



To select one of the sub menu voices press SRC button.
In the example below we visualize HOUR.

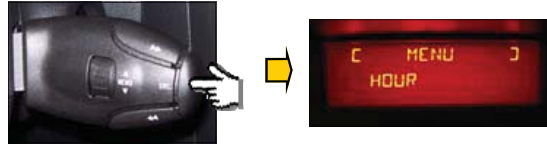

Each time we will press SEEK >> button, we will increase the HOUR.
To decrease press SEEK << button.



To confirm press SRC button.



The menu selection logic is the same for all sub menu voices.
Below a simplified description.

Enter menu

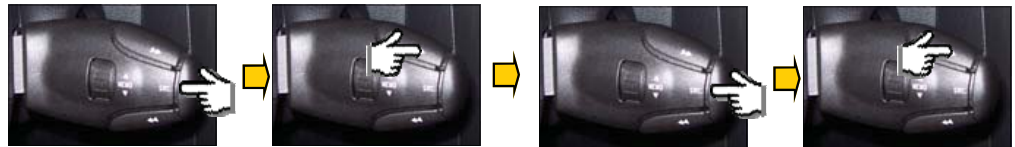

Scroll Main Menu



Scroll Sub Menu



Confirm selection



Menu setting it's under time, if any button is pressed within 30 seconds the system exit automatically. To re-activate the menu just press volume +



Once ended the setting switch OFF the ignition and extract the key.