

Ford Fiesta 11/2005 →  
 Ford Focus 01/2005 →  
 Ford Focus C-MAX 01/2005 →  
 Ford Fusion 11/2005 →

Ford Galaxy 2006 →  
 Ford S-MAX 2006 →  
 Ford Transit 2006 →

Colour	Part-No.: Standard	Part-No.: Rubber-Touch
black	CAW 2114-15-1	CAW 2114-15-1-RT
anthracite	CAW 2114-15-2	CAW 2114-15-2-RT
silver	CAW 2114-15-3	CAW 2114-15-3-RT

Compatible with these Kenwood double DIN devices

### Kenwood Navigation

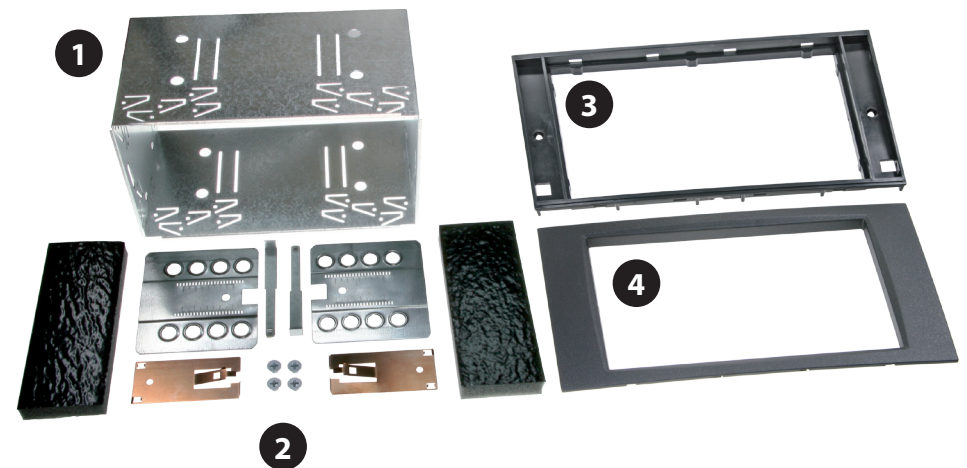

Double DIN Set contents

- (1) Metal Frame
- (2) Installation Kit
- (3) Facia Plate
- (4) Trim Frame

**Not compatible for Ford with these OEM head units!**



Oval shaped Ford OEM head unit

- 6000 CD (oval shape)
- Audio SONY 6CD (oval shape)
- Travel Pilot X (oval shape)

Please use our part-no.:  
CAW 2114-19-B (black)  
CAW 2114-19-S (silver)  
instead

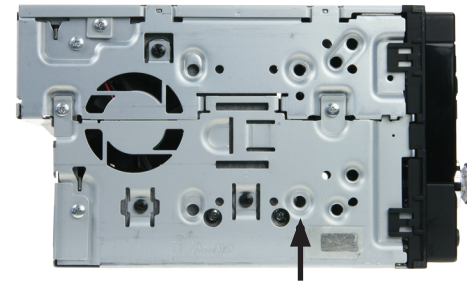

Mount the metal brackets with the double DIN head unit

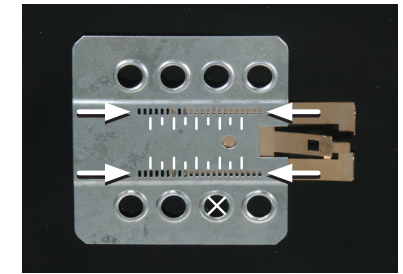

The position of the copper coloured holder can be adjusted to your needs for perfect fit. (see sample)

**Ford with other audio systems**

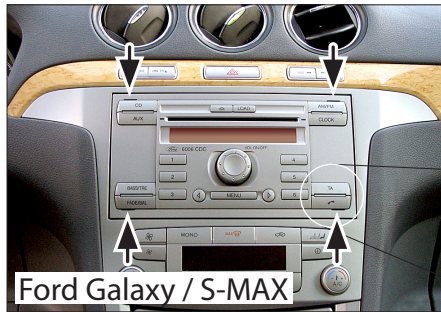

Ford Galaxy / S-MAX

1. Insert Ford radio release keys in the holes of the OEM head unit. Remove OEM head unit by pulling it towards your direction.

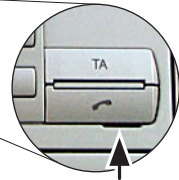

Ford Focus



Ford Fiesta



2. Place the facia plate on the dashboard.

Push the metal frame into the facia plate.

Connect all required circuit points and push the double DIN head unit until it snaps in.

Place the trim frame.

Reinstall everything in reverse order to finish installation.

All installation work must be performed by a qualified professional installer only. The manufacturer / dealer is not liable for any kind of incidental or indirect damages.