

## CAW-CANUN2

Universal Steering Wheel Remote Control Adaptor  
 Universal-Lenkradfernbedienungsadapter  
 Interface Universelle pour télécommande au volant d'origine  
 Interfaccia Universale per comandi al volante d'origine  
 Interfase Universal para mandos de volante originales

rev 1.0 14

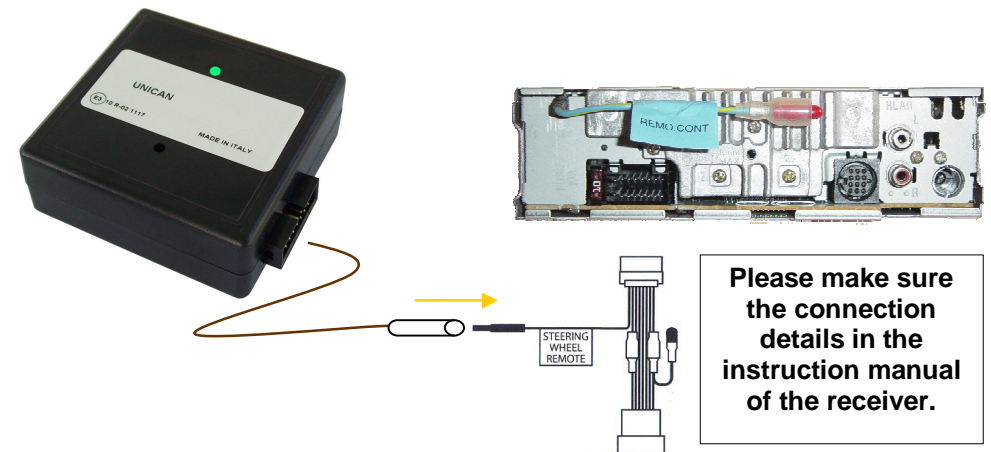

### Radio protocol selection procedure

**KENWOOD**

PRESS SEEK +



**JVC**

PRESS VOLUME + FOLLOWED BY SEEK +



#### WARRANTY

**THIS PRODUCT IS COVERED BY TWO-YEAR GUARANTEE FOR ANY MANUFACTURING TROUBLES. THE WARRANTY IS VALID IF ACCOMPANIED BY THE INVOICE OF PURCHASE**

The information in this guide are purely for information purposes, therefore, are subject to change without notice. At the time of publication the information is correct and reliable. However the distributor can not be held responsible for any consequences resulting from errors or omissions in this manual. We reserves the right to improve / change the product or manual without obligation to notify users.

**Self-Learning / Selbstlern-Funktion**  
**Auto-apprentissage / Auto-apprendimento / Auto-aprendizaje**

Power Plug.  
 Stromanschluss.  
 Branchement.  
 Alimentare l'Unità.  
 Conexión de alimentación.



LED blinks red for few seconds.  
 Die LED blinkt für einige Sekunden rot.  
 Le LED clignote en rouge quelques secondes.  
 Il LED lampeggia rosso qualche secondo.  
 El LED rojo parpadea unos segundos.



LED blinks green: it must to select the radio protocol  
 Wenn die LED grün blinkt, wählen Sie bitte das entsprechende Radioprotokoll (siehe Seite 1) aus.  
 LED clignote en vert: il doit choisir le protocole de la radio  
 Il LED lampeggia verde, bisogna selezionare il protocollo radio.  
 LED parpadea en verde: se debe seleccionar el protocolo de la radio



To select one of the sub menu voices press SRC button.  
 In the example below we visualize HOUR.



Each time we will press SEEK >> button, we will increase the HOUR.  
 To decrease press SEEK << button.



To confirm press SRC button.

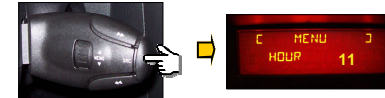

The menu selection logic is the same for all sub menu voices.  
 Below a simplified description.

Enter menu

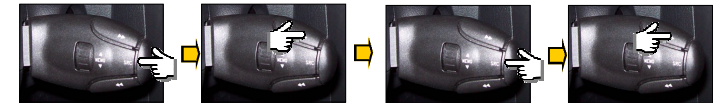

Scroll Main Menu



Scroll Sub Menu



Confirm selection



Menu setting it's under time, if any button is pressed within 30 seconds the system exit automatically. To re-activate the menu just press volume +



Once ended the setting switch OFF the ignition and extract the key.

## PSA MENU SETTING

**UNICAN** allows you to set some functions that usually are managed with the OEM head unit . By making a simple and intuitive procedure it's possible to set functions such as:

- Hour
- Date
- Language
- General Setting



**ATTENTION**  
THE MENU' AVAILABILITY IT'S UNDER TIME, IF ANY BUTTONS IS PRESSED WITHIN 30 SECONDS, THE SYSTEM EXIT AUTOMATICALLY. TO RESET THE SETTING FUNCTION ONCE ENDED THE MODIFICATIONS, DISCONNECT THE IGNITION KEY. ,

### How to enter the menu setting

To enter the menu setting just turn on the ignition, switch OFF the radio, then press the sequence of buttons MODE and SEEK >> twice. Once done this operation the car display will visualize the voice MENU.



Each time we will press SEEK >> button, we will navigate the Main Menu.

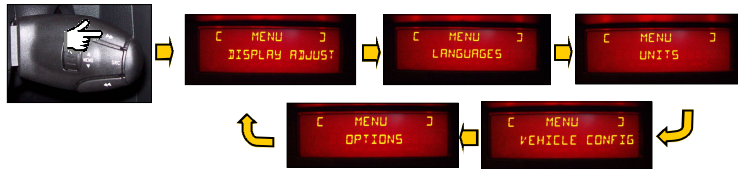

To select one of the Sub Menu press SRC button. In the example below we visualize DISPLAY ADJUST in which we can modify hours and date.



Each time we will press MEMO V button, we will navigate the DIPLAY ADJUST sub menu.

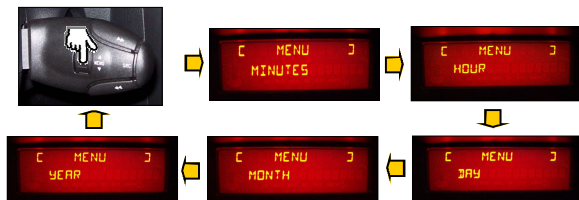

## Reset Procedure

### WARNING!



IF YOU NEED TO RESET THE UNIT OR RE-INSTALL IT IN A NEW CAR (EVEN IF IN A SAME GROUP MODEL) IT IS NECESSARY TO RESET THE MODULE.

### RESET:

1. WITH THE UNIT POWERED, PRESS AND KEEP PRESSED THE UNIT BUTTON TILL THE LED SWITCH OFF.
2. WITH THE LED SWITCHED OFF RELEASE THE BUTTON, THE RESET IS DONE.



**Achtung!**  
Bitte stellen Sie den Ausgangszustand, was auch bei einer Verwendung des Adapters in einem anderen Fahrzeug, selbst bei gleicher Marke und Modell, gemacht werden soll, wie folgt her:

1. Zunächst den Adapter anschliessen und in Betrieb nehmen, dann den Taster in der Gehäusemitte des Adapters drücken und gedrückt halten bis die LED erlischt.
2. Nachdem die LED erloschen ist, den Taster loslassen und fertig ist das Zurücksetzen.



### ATTENTION!

SI VOUS DEVEZ REINITIALISER L'APPAREIL OU RE-INSTALLER DANS UN NEUF VEHICULE (MÊME SI DANS UN MEME GROUPE / MODEL), IL FAUT REINITIALISER KE MODULE.

### RESET:

1. AVEC LA UNITE ALIMENTEE, APPUYER ET MAINTENIR APPUYE SUL LE BOUTON JU-SQU'A DA LUMIERE D'UNICAN S'ETEINT.
2. AVEC LA LUMIERE ÉTEINT RELACHEZ LE BOUTON, LA REINITIALISATION EST TERMI-



### ATTENZIONE!

SE SI VUOLE INSTALLARE LA STESSA INTERFACCIA SU UNA NUOVA VETTURA (ANCHE SE DI UNO STESSO GRUPPO) E' NECESSARIOESEGUIRE IL RESET DEL MODULO.

### RESET:

1. CON L'UNITA' ALIMENTATA PREMERE E TENERE PREMUTO IL PULSANTE DEL MODULO FINO A CHE IL LED SI SPENGA.
2. CON IL LED SPENTO RILASCIARE IL PULSANTE, IL RESET E ESEGUITO.



### ADVERTENCIA!

SI USTED NECESITA REINICIAR LA UNIDAD O RE-INSTALAR EN UN NUEVO VEHÍCULO (AUNQUE EN UN MISMO GRUPO MODELO), ED NECESARIO REINICIAR EL MODULO.

### RESET:

1. CONECTAR LA UNIDAD, PULSAR Y MANTENER PULSADO EL BOTON DEL MODULO HASTA EL LED SE APAGA.
2. CON EL LED APAGADO SOLTAR EL BOTON, EL RESET SE HACE.

Functions / Funktionen / Fonction / Funzioni / Funciones			
	RADIO	CASSETTE	CD
1	INCREASE VOLUME		
2	DECREASE VOLUME		
3	SEEK +	NEXT TRACK	
4	SEEK -	PREVIOUS TRACK	
5	FM		
6	AM		
7	SOURCE / CLOSE CALL		
8	MUTE		
9	ANSWER CALL		
10	CLOSE CALL		

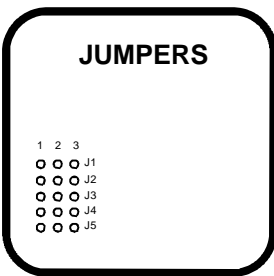

	1 - 2	2 - 3
J1		
J2		
J3		
J4		
J5	K-BUS HANDLING	CAN-BUS HANDLING

TECHNICAL CHARACTERISTICS	
POWER SUPPLY	10/16 VDC
ABSORPTION AT REST	0,001 A
ABSORPTION WHEN WORKING	0,040 A
MAX CHARGE IGNITION OUTPUT	2,000 A
MAX CHARGE SIDELIGHTS / HANDBRAKE / REVERSE GEAR OUTPUT / ODOMETRIC SIGNAL	0,040 A

In the example the minutes are 08.  
 If we want to increase press SEEK ^ button.  
 If we want to decrease press SEEK v button.

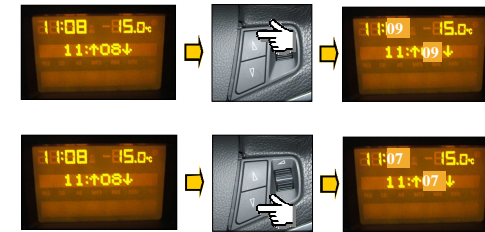

Once the HOUR setting is done by pressing the ◀▶ button will be displayed the MENU voice for the DATE setting ↑DD ↓MM YEAR.

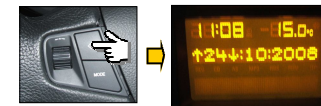

In the example the day is 24th.  
 If we want to increase press SEEK ^ button.  
 If we want to decrease press SEEK v button.



Once the DAY setting is done by pressing the ◀▶ button we will display the MENU DD MM YEAR that is the MONTH setting, by pressing the ◀▶ button again will be displayed DD MM↑YEAR↓ that is the YEAR setting. The setting are managed always with SEEK ^ button to increase or SEEK v button to decrease.

Other MENU voices are available after TIME and DATE :  
 IGN LOGIC OFF  
 LANGUAGE  
 To change them just press SEEK ^ or SEEK v buttons.  
 Once the setting is done wait the automatic exit from the MENU, then switch OFF the ignition and extract the car key.

## OPEL MENU SETTING

**UNICAN** allows you to set some functions that usually are managed with the OEM head unit . This function was tested with ANTARA model 2009.  
By making a simple and intuitive procedure it's possible to set functions such as:

- Hour
- Date
- Language
- General Setting

### ATTENTION



**THE MENU' AVAILABILITY IT'S UNDER TIME, IF ANY BUTTONS IS PRESSED WITHIN 30 SECONDS, THE SYSTEM EXIT AUTOMATICALLY. TO RESET THE SETTING FUNCTION ONCE ENDED THE MODIFICATIONS, DISCONNECT THE IGNITION KEY.**

### How to enter the menu setting

To enter the menu setting just turn on the ignition, switch OFF the radio, then press the sequence of buttons ◀▶ and MODE twice. Once done this operation the car display will visualize the voice MENU.

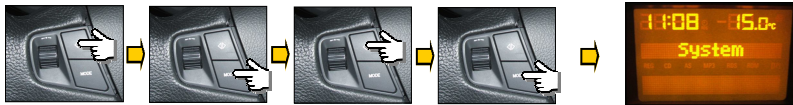

Now by pressing ◀▶ button will be displayed the first MENU voice CLOCK SYNC OFF. Jump this function by pressing ◀▶ once again in order to display the MENU voice ↑HH↓ MM that allows to set the HOURS.



In the example it's 11 o'clock.  
If we want to increase press SEEK ▲ button.  
If we want to decrease press SEEK ▼ button.

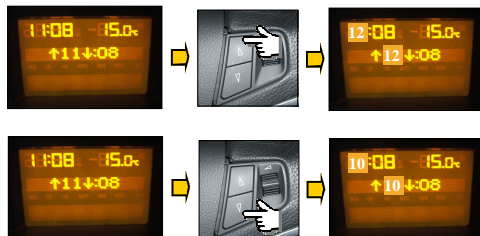

Now by pressing ◀▶ button will be displayed the second voice of the MENU HH↑MM↓ That allows to set the MINUTES.

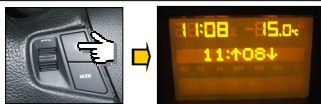

## FUNCTIONS SETTING

The module on default manage some functions. However sometime the enduser prefers other functions instead of those chosen by JVC KENWOOD. For this reason it was inserted a new procedure that allows to set a series of functions. First of all it is important that the unit had recognised a car canbus protocol. So the LED must be light GREEN.



Now press 3 times the module button and you will see that the LED will flash RED. The number of flashes are to determinate which car protocol was selected by the unit.

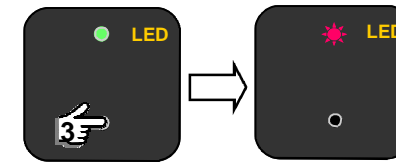

Now turn the ignition ON of the car 3 times. The LED will flash YELLOW with intervals of 1 flash and one pause.

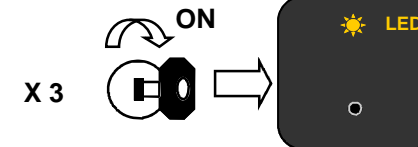

The number of the flashes means the number of the options we can change, by pressing quickly the module button, we will jump to the second option available and so on for all the options available in this module version. If we need to **change** the default state of an option, make a long press on the unit till the led change its state. After a little switch off, the led will light fixed green

OPTION AND FLASH NUMBERS	DEFAULT	OPTION
1	SEEK ALWAYS AVAILABLE	SEEK AVAILABLE FOR 10 SEC AFTER A VOLUME PRESS
2	HANDBRAKE AVAILABLE WHEN HANDBRAKE IS ON	ODOMETRIC HANDBRAKE AVAILABLE WHEN THE CAR IS UNDER 3 Km/h OF SPEED
3	SEEK ALWAYS AVAILABLE	ODOMETRIC SEEK AVAILABLE WHEN THE CAR IS OVER 3 Km/h OF SPEED
4	SPEED PULSE FREQUENCY 26000 PULSE PER MILE	SPEED PULSE FREQUENCY 4000 PULSE PER MILE
5	SEEK AVAILABLE IN AUDIO MENU (Mercedes)	SEEK ALWAYS AVAILABLE
6	TELEPHONE BUTTONS ACTIVE (ONLY FOR RADIOS COMPATIBLE)	TELEPHONE BUTTONS NOT ACTIVE (ONLY FOR RADIOS COMPATIBLE)
7	PARKING SENSOR BUZZER SIGNAL DISABLED	PARKING SENSOR BUZZER SIGNAL ENABLED ON HANDBRAKE OUTPUT
8	AMPLIWAKE UP ON	AMPLIWAKE UP OFF
9	RESISTIVE RADIO CODE IMPULSED	RESISTIVE RADIO CODE CONTINUOUS
10	IGNITION INTERRUPTED WHEN KEY IS OFF (ONLY JEEP GRAND CHEROKEE)	IGNITION INTERRUPTED WHEN KEY IS PULLED OUT (ONLY JEEP GRAND CHEROKEE)
11	HAND BRAKE OUTPUT	FIAT BLUE&ME MUTE AVAILABLE ON THE HANDBRAKE OUTPUT
12	SEEK ALWAYS AVAILABLE	SEEK AVAILABLE IN AUDIO MENU (Volkswagen)
13	N/A	N/A
14	N/A	N/A
15 ONLY FOR OPEL ZAFIRA 1C	HANDBRAKE OUTPUT AVAILABLE WHEN HANDBRAKE ON	GND OUTPUT WHEN CAR REMOTE CONTROL IS OFF
16 ONLY FOR OPEL ZAFIRA 1C	REVERSE GEAR OUTPUT AVAILABLE WHEN REVERSE GEAR INSERTED	12V OUTPUT WHEN CAR DOOR OPEN

### PROFILE 7 HANDBRAKE OUTPUT CONNECTIONS

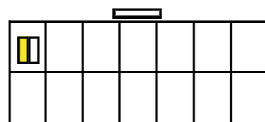
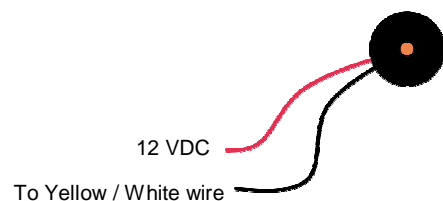

CAW-CANUN2 wires side view

Connect the buzzer to the black wire of the buzzer with the yellow / white wire from the CAW-CANUN2

Car / Fahrzeug Vehículo / Veicolo Vehículo	Year Baujahr Année / Anno Año			SPEED		AMPLI WAKE UP			
<b>MERCEDES</b>									
SL	From 2006	○	○	○	○	○	○	○	○
NEW CLASS C	From 2007	○	○	○	○	○	○	○	○
SPRINTER	From 2006	○	○	○	○	○	○	○	○
<b>OPEL</b>									
CORSA	From 2004	○	○	○	○	○	○	○	○
ASTRA H	From 2004	○	○	○	○	○	○	○	○
MERIVA	From 2004	○	○	○	○	○	○	○	○
NEW VECTRA	From 2004	○	○	○	○	○	○	○	○
SIGNUM	From 2004	○	○	○	○	○	○	○	○
TIGRA	From 2004	○	○	○	○	○	○	○	○
NEW ZAFIRA	From 2004	○	○	○	○	○	○	○	○
ANTARA	From 2006	○	○	○	○	○	○	○	○
<b>PEUGEOT</b>									
107	From 2007	○	○	○	○	○	○	○	○
207	From 2006	○	○	○	○	○	○	○	○
307	From 2006	○	○	○	○	○	○	○	○
308	From 2008	○	○	○	○	○	○	○	○
407	From 2006	○	○	○	○	○	○	○	○
<b>PORSCHE</b>									
CAYENNE TURBO	From 2006	○	○	○	○	○	○	○	○
BOXTER	From 2006	○	○	○	○	○	○	○	○
CAYENNE	From 2010	○	○	○	○	○	○	○	○
<b>RENAULT</b>									
MODUS	From 2006	○	○	○	○	○	○	○	○
CLIO	From 2006	○	○	○	○	○	○	○	○
MEGANE	From 2006	○	○	○	○	○	○	○	○
LAGUNA	From 2006	○	○	○	○	○	○	○	○
ESPACE	From 2006	○	○	○	○	○	○	○	○
LAGUNA III	From 2009	○	○	○	○	○	○	○	○
MEGANE III	From 2009	○	○	○	○	○	○	○	○
KOLEOS	From 2009	○	○	○	○	○	○	○	○
<b>SEAT</b>									
ALTEA	From 2004	○	○	○	○	○	○	○	○
CORDOBA	From 2004	○	○	○	○	○	○	○	○
LEON	From 2004	○	○	○	○	○	○	○	○
IBIZA 2009	From 2009	○	○	○	○	○	○	○	○
<b>SKODA</b>									
OCTAVIA II	From 2006	○	○	○	○	○	○	○	○
YETI	From 2010	○	○	○	○	○	○	○	○
SUPERB	From 2010	○	○	○	○	○	○	○	○
<b>VOLKSWAGEN</b>									
GOLF V	From 2004	○	○	○	○	○	○	○	○
GOLFPPLUS	From 2004	○	○	○	○	○	○	○	○
TOURAN	From 2004	○	○	○	○	○	○	○	○
PASSAT	From 2004	○	○	○	○	○	○	○	○
TOUAREG	From 2004	○	○	○	○	○	○	○	○
NEW TOUAREG	From 2007	○	○	○	○	○	○	○	○
EOS	From 2007	○	○	○	○	○	○	○	○
MULTIVAN	From 2007	○	○	○	○	○	○	○	○
TIGUAN	From 2007	○	○	○	○	○	○	○	○
PASSAT CC	From 2008	○	○	○	○	○	○	○	○
GOLF VI	From 2008	○	○	○	○	○	○	○	○
SCIROCCO	From 2008	○	○	○	○	○	○	○	○
POLO	From 2009	○	○	○	○	○	○	○	○

Compatibility Kompatibilität Compatibilite Compatibilità Compatibilidad										
Car / Fahrzeug Vehículo / Veicolo Vehículo	Year Baujahr Année / Anno Año				SPEED			AMPLI WAKE UP		
<b>ALFA ROMEO</b>										
159	From 2005	○	○	○	○	○	○	x	x	
BRERA	From 2006	○	○	○	○	○	○	x	x	
SPIDER	From 2006	○	○	○	○	○	○	x	x	
MITO	From 2008	○	○	○	○	○	○	x	x	
<b>AUDI</b>										
A3	From 2004	○	○	○	○	○	○	x	x	
A4	From 2004	○	○	○	○	○	○	x	x	
A6	From 2004	○	○	○	○	○	x	x	x	
Q7	From 2006	○	○	○	○	○	x	x	x	
A5	From 2007	○	○	○	○	○	○	x	x	
TT	From 2007	○	○	○	○	○	x	x	x	
A1	From 2011	○	○	○	○	○	○	x	x	
<b>BMW</b>										
SERIES 1 - 3 - 5 - X5 - X6	From 2005 From 2008	○	○	○	○	○	○	x	○	
MINI	From 2010	○	○	○	○	○	○	x	x	
X3 - X5 - MINI (K-BUS)	From 2003	○	x	x	x	x	x	x	x	
SERIES 5 GT	From 2010	○	○	○	x	○	x	x	x	
<b>CHRYSLER / DODGE</b>										
JEEP GRAND CHE- ROKEE	From 2005	○	○	○	○	○	○	FROM 08	x	
300C	From 2005	○	○	○	○	○	○	FROM 08	x	
COMPASS	From 2006	○	○	○	○	○	○	FROM 08	x	
NITRO	From 2007	○	○	○	○	○	○	FROM 08	x	
CALIBER	From 2008	○	○	○	○	○	○	FROM 08	x	
VOYAGER	From 2008	○	○	○	○	○	○	FROM 08	x	
<b>CITROEN</b>										
C2	From 2006	○	○	○	○	○	○	x	x	
C3	From 2006	○	○	○	○	○	○	x	x	
C4	From 2006	○	○	○	○	○	○	x	x	
C4 PICASSO	From 2006	○	○	○	○	○	○	x	x	
C5	From 2008	○	○	○	○	○	○	x	x	
<b>FIAT</b>										
IDEA	From 2005	○	○	○	○	○	○	x	x	
NEW CROMA	From 2005	○	○	○	○	○	○	x	x	
GRANDE PUNTO	From 2006	○	○	○	○	○	○	x	x	
SCUDO	From 2007	○	○	○	○	○	○	x	x	
STILO	From 2006	○	○	○	○	○	○	x	x	
BRAVO	From 2007	○	○	○	○	○	○	x	x	
500	From 2007	○	○	○	○	○	○	x	x	
<b>LANCIA</b>										
YPSILON	From 2006	○	○	○	○	○	○	x	x	
NEW DELTA	From 2008	○	○	○	○	○	○	x	x	
<b>MERCEDES</b>										
CLASS A	From 2003	○	○	○	○	○	○	x	○	
CLASS B	From 2004	○	○	○	○	○	○	x	○	
CLASS C	From 2003	○	○	○	○	○	○	x	○	
CLASS E	From 2004	○	○	○	○	○	x	x	○	
CLK	From 2003	○	○	○	○	○	○	x	○	
SLK	From 2003	○	○	○	○	○	○	x	○	
CLASS R	From 2006	○	○	○	○	○	○	x	○	
NEW SERIES S	From 2006	○	○	○	○	x	x	x	○	
ML	From 2004	○	○	○	○	○	○	x	○	
NEW ML	From 2005	○	○	○	○	○	○	x	○	
GL	From 2006	○	○	○	○	○	○	x	○	
GLK	From 2010	○	○	○	○	○	○	x	○	

CAW-CANUN2 LED STATUS
1 - LED RED FAST BLINKING - No car selected - Reading CANBUS line
2 - LED RED SLOW BLINKING - Manual car selection
3 - LED GREEN SLOW BLINKING - Car selected but radio profile not selected
4 - LED YELLOW SLOW BLINKING - Manual options selection
5 - LED YELLOW FAST BLINKING - Upgrading in progress
6 - LED FIXED RED - Found CANBUS line but it can't associate a car profile
7 - LED FIXED GREEN - Car selected - Radio selected

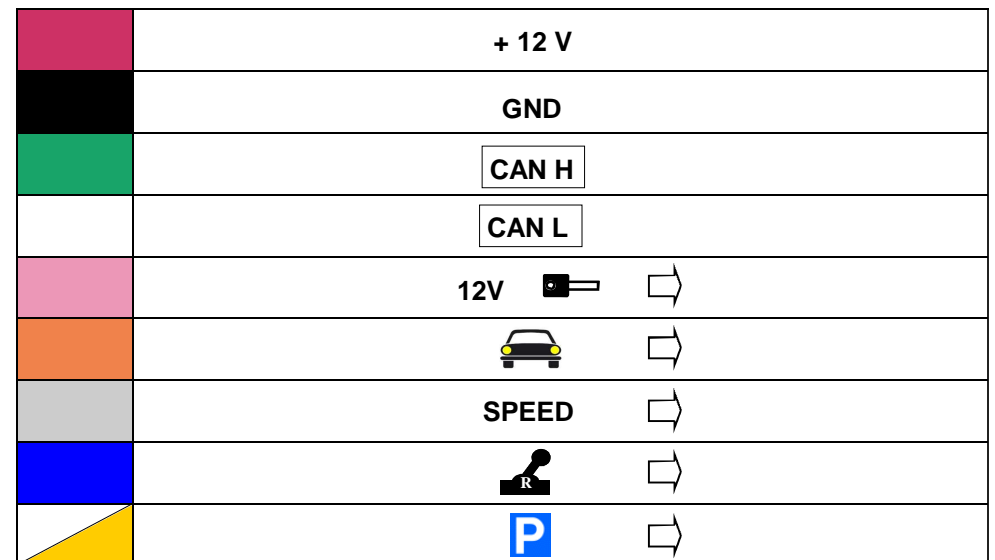

## CANBUS CONNECTIONS (SEEN FROM CABLE OUPUT OF CONNECTORS) rev 2.13

**ALFA ROMEO**  
 159 - BRERA - SPIDER

CAN H GREEN  
 CAN L WHITE

SPEAKER

ISO CONNECTOR  
AUTORADIO

BUTTONS	+	-	▲	▼	▲	▼	🔊	SCR
FUNCTIONS	1	2	3	4	6	5	8	7

**AUDI**  
 A3 A4 A5 A6 TT Q7

CAN H GREEN  
 CAN L WHITE

CANBUS CONNECTIONS ON ISO AUDI

CANBUS CONNECTIONS ON FAKRA AUDI

BUTTONS	+	-	▲	▼
FUNCTIONS	1	2	3	4

**AUDI**  
 A1 Q3

CAN H GREEN  
 CAN L WHITE

CONNECTORS ARE BACK THE RADIO

CANBUS CONNECTIONS ON FAKRA AUDI

**SERIES**  
 1 3 5  
 SERIE 5 GT 2010

CAN H GREEN  
 CAN L WHITE

BUTTONS	+	-	▲	▼
FUNCTIONS	1	2	3	4

SERIES 1 3 5

**K-BUS PROTOCOL**

K BUS VIOLET BLACK

BUTTONS	+	-	▲	▼
FUNCTIONS	1	2	3	4

OLD K BUS

X3 X5 MINI

## CANBUS CONNECTIONS (SEEN FROM CABLE OUPUT OF CONNECTORS) rev 2.13

**ALTEA - CORDOBA - LEON**

CAN H GREEN  
 CAN L WHITE

BUTTONS	+	-	◀	▶	🔄	🔊
FUNCTIONS	1	2	4	3	7	8

CANBUS CONNECTIONS ON FAKRA SEAT

**OCTAVIA II - YETI - SUPERB**

CAN H GREEN  
 CAN L WHITE

BUTTONS	+	-	◀	▶	🔄	🔊
FUNCTIONS	1	2	4	3	7	8

CANBUS CONNECTIONS ON FAKRA SKODA

**FORTWO**

	GREEN		CH WHITE / GREEN (POS 6)
	WHITE		CL GREEN (POS 9)

WIRES ARE UNDER THE DASHBOARD NEAR THE STEERING WHEEL

**POLO 2009 - GOLF V - GOLFPLUS - TOURAN**  
 PASSAT - TOUAREG  
 NEW TOUAREG - EOS  
 MULTIVAN - TIGUAN

CAN H GREEN  
 CAN L WHITE

BUTTONS	+	-	◀	▶	🔄	🔊
FUNCTIONS	1	2	4	3	7	8

CANBUS CONNECTIONS ON FAKRA VW

**GOLF VII**

CAN H GREEN  
 CAN L WHITE

CONNECTORS ARE BACK THE RADIO

CANBUS CONNECTIONS ON FAKRA

**V70**

BUTTONS	+	-	◀	▶
FUNCTIONS	1	2	4	3

CAN H GREEN

CAN L WHITE



**CANBUS CONNECTIONS**  
(SEEN FROM CABLE OUPUT OF CONNECTORS) rev 2.13

**MERCEDES**  
A - SPRINTER  
VIANO - VITO

CONNECTORS ARE BACK THE RADIO

CAN H GREEN	
CAN L WHITE	

**CLASSE A  
CON ISO**

**OPEL**  
CORSA - ASTRA H - MERIVA  
NEW VECTRA  
SIGNUM - TIGRA - NEW ZAFIRA  
ANTARA

BUTTONS	VOL +	VOL -	▲	▼	🎵	📶
FUNCTIONS	1	2	4	3	7	8

CAN H GREEN	
CAN L WHITE	

**CANBUS CONNECTIONS  
ON FAKRA OPEL**

**PORSCHE**  
CAYENNE TURBO

BUTTONS	+	▲	▼	▶	▶	🎵	MUTE
FUNCTIONS	1	2	4	3	7	8	

CAN H GREEN	
CAN L WHITE	

**ISO PORSCHE**

**RENAULT**  
MODUS - CLIO - MEGANE  
LAGUNA - ESPACE

BUTTONS	+	-	↺	↻	🎵	SCR
FUNCTIONS	1	2	4	3	8	7

CAN L WHITE	
CAN H GREEN	

**KOLEOS**

CAN L WHITE	
CAN H GREEN	

**CANBUS CONNECTIONS  
ON FAKRA RENAULT**

**CANBUS CONNECTIONS**  
(SEEN FROM CABLE OUPUT OF CONNECTORS) rev 2.13

**FAKRA**  
C2 - C3 - C4  
207 - 307 - 407 - 508

BUTTONS	VOL +	VOL -	◀	▶	▲	▼	VOL + & -	MODE
FUNCTIONS	1	2	4	3	6	5	8	7

CAN H GREEN	
CAN L WHITE	

**CHRYSLER**  
CH WHITE/ORANGE (POS 5)  
CL WHITE (POS 6)

LEFT LEVER BEHIND ST. WHEEL  
RIGHT LEVER BEHIND ST. WHEEL

4	1
7	8
3	2

CAN H GREEN	
CAN L WHITE	

**J. GRAND CHEROKEE  
COMPASS  
300 C**

**Jeep**  
Dodge  
NITRO  
COMPASS 2012

CL WHITE/ORANGE (POS 2)  
CH WHITE/GREY (POS 13)

LEFT LEVER BEHIND ST. WHEEL  
RIGHT LEVER BEHIND ST. WHEEL

4	1
7	8
3	2

CAN L WHITE	
CAN H GREEN	

**NITRO  
COMPASS 2012**

**FIAT**  
LANCIA  
GRANDE PUNTO  
IDEA - CROMA - STILO - BRAVO  
500-PANDA 2013

YPSILON

BUTTONS	+	-	▲	▼	🎵	SCR
FUNCTIONS	1	2	3	4	8	7

CAN H GREEN	
CAN L WHITE	

**SPEAKER**  
**ISO AUTORADIO  
CONNECTOR**

**FIAT**  
CONNECTORS ARE BACK THE RADIO  
FREEMONT

CAN H GREEN	
CAN L WHITE	

## CANBUS CONNECTIONS (SEEN FROM CABLE OUPUT OF CONNECTORS) rev 2.13

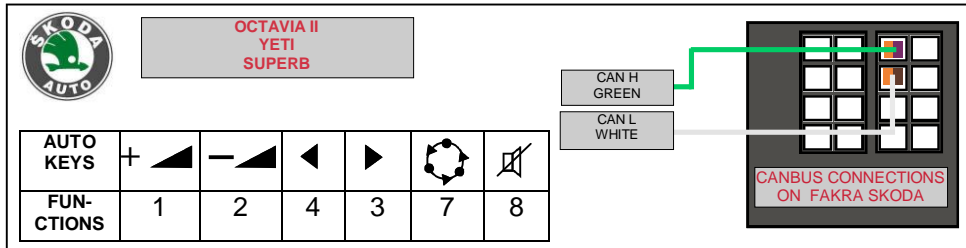
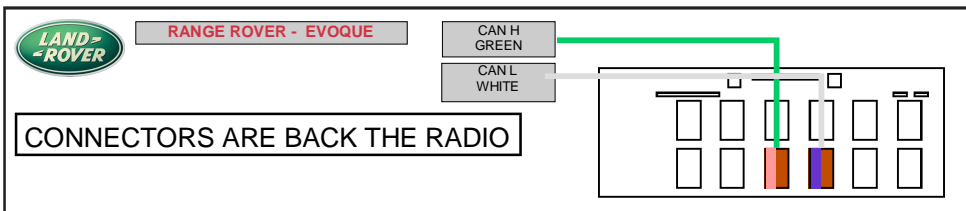
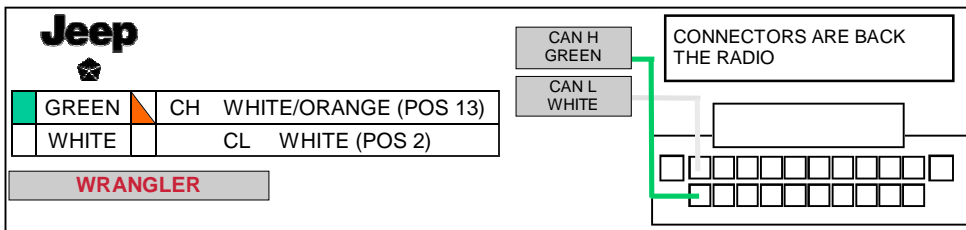
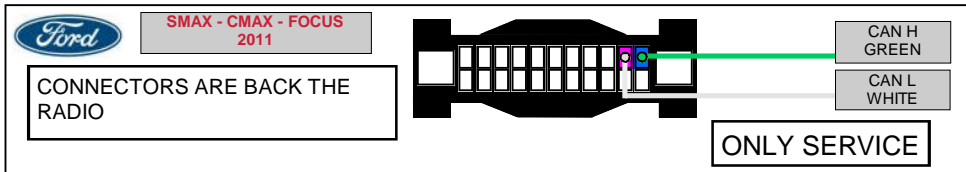
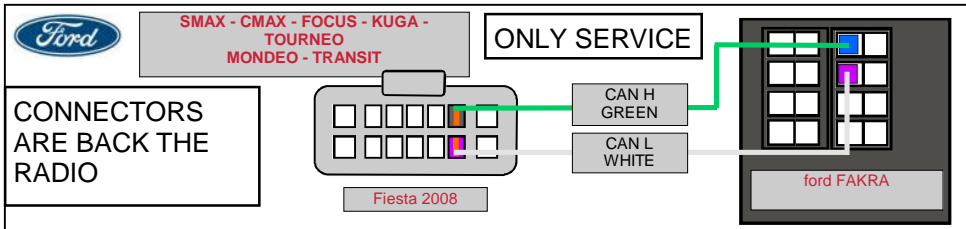

## CANBUS CONNECTIONS (SEEN FROM CABLE OUPUT OF CONNECTORS) REV 4.11

